

NOTE: ALL EXISTING OVERHEAD UTILITIES SHALL BE BURIED UNDERGROUND.

EXISTING ø2" HDPE RESIDENTIAL WATER LINE SERVICE  
EXISTING ø8" PVC SEWER  
NW 6TH STREET

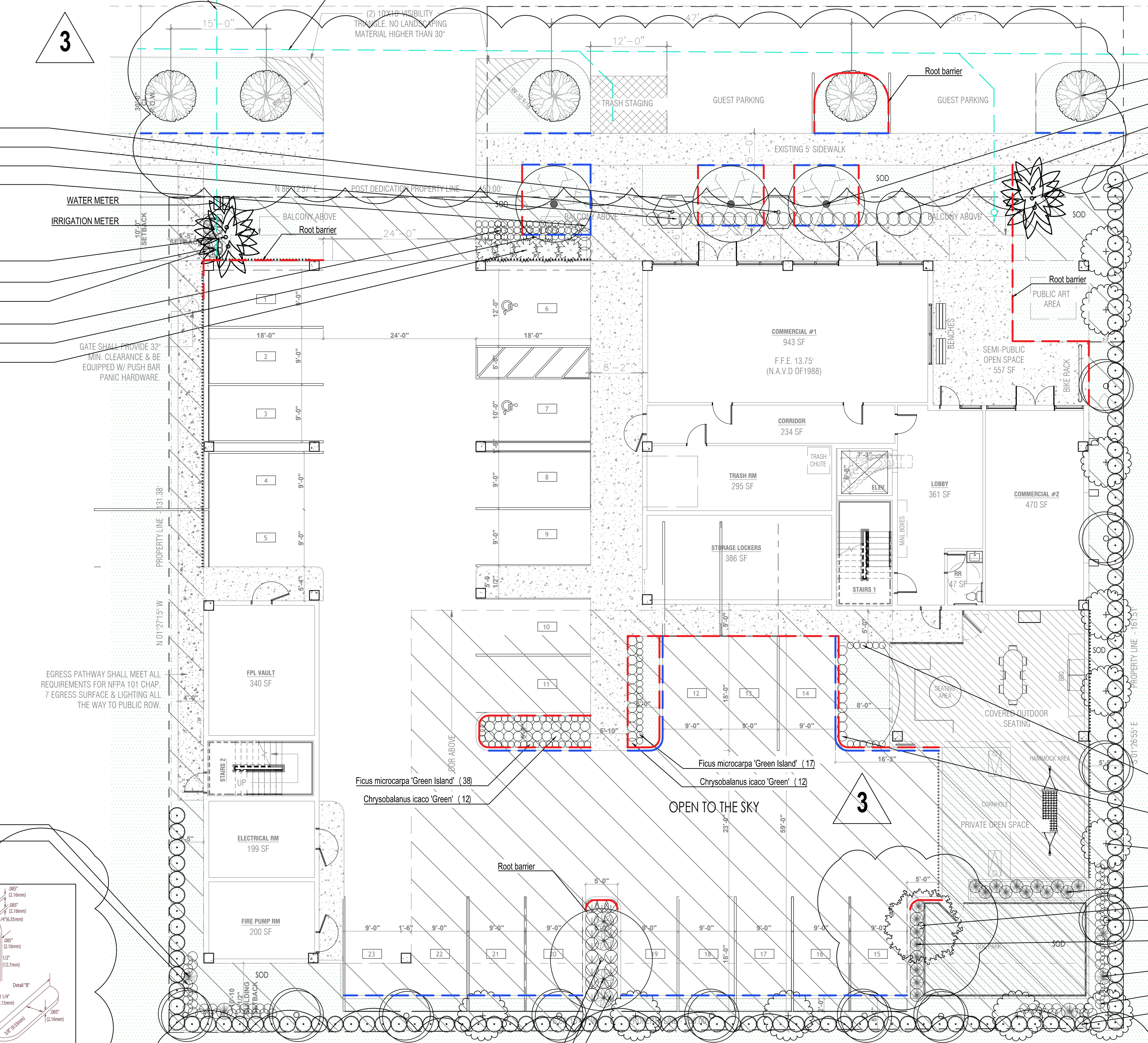

Pervious calculations:  
Lot area: 22,718 sq ft ----- 100%  
Permeable area: 3,952 sq ft ----- 17.40 %

NOTES:

- All overhead utilities will be buried for this project as per 155.5509
- Pre Construction meeting with Urban Forestry is required before any work is performed onsite
- All road rock, concrete, asphalt and other non natural material be removed from all planting areas prior to landscape installation and be replaced with planting soil prior to landscape installation.
- All hedges abutting City Rights of way are maintained at a height no greater than 24". It is staffs recommendation that all trees VUA perimeter trees be 14' OA to create a largest CPTED clear line of sight from roadway.
- Landscaping materials other than sod are not allowed within (5') five feet of any portion of City-owned utilities within the public street right-of-way including meters, hydrants, service lines, etc.
- as per City Ordinance(s) 50.02(A) (4) and 100.35(E), street trees shall not be placed on top of or 5of either side of any City-owned utility infrastructure.
- No trees, shrubbery, or obstruction shall be placed within a 3 radius of a City-owned sewer lateral cleanout or water &/or reuse meter.
- Plant spacing shall supersede plant quantity to fill the bed.
- Foundation footers shall not be in conflict with required landscaping requirements and suspend pavement cell areas
- Egress pathway shall meet all requirements for npa 101 chap. 7 egress surface & lighting all the way to public row.
- Any proposed changes to the above will require immediate notification to Urban Forestry staff in writing and approval from Urban Forestry staff prior to the proposed changes.

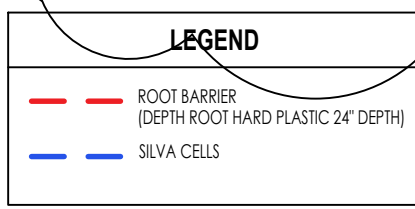

Install 24" DeepRoot HDPE root barrier at all locations where tree or large shrub planting areas are within 5 feet of hardscapes or underground utilities. Refer to detail for installation method on L-103 sheet.

All root barriers to be installed prior to planting and verified in field by landscape inspector.

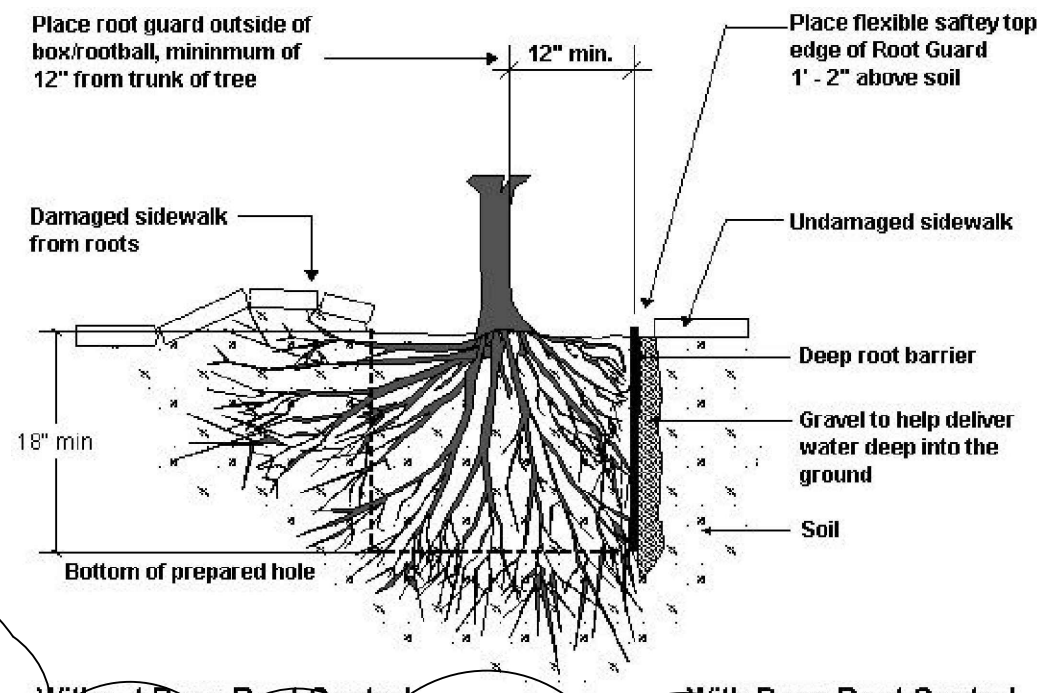

Without Deep Root Control With Deep Root Control

NOTE: For medium canopy trees:  
Cell system: Silva Cell SC-2  
# of cells: 80  
Soil volume per cell: 15 CF  
Total soil volume = 80 x 15 = 1,200 CF

GRAPHIC SCALE  
0' 5' 10' 20' 30'

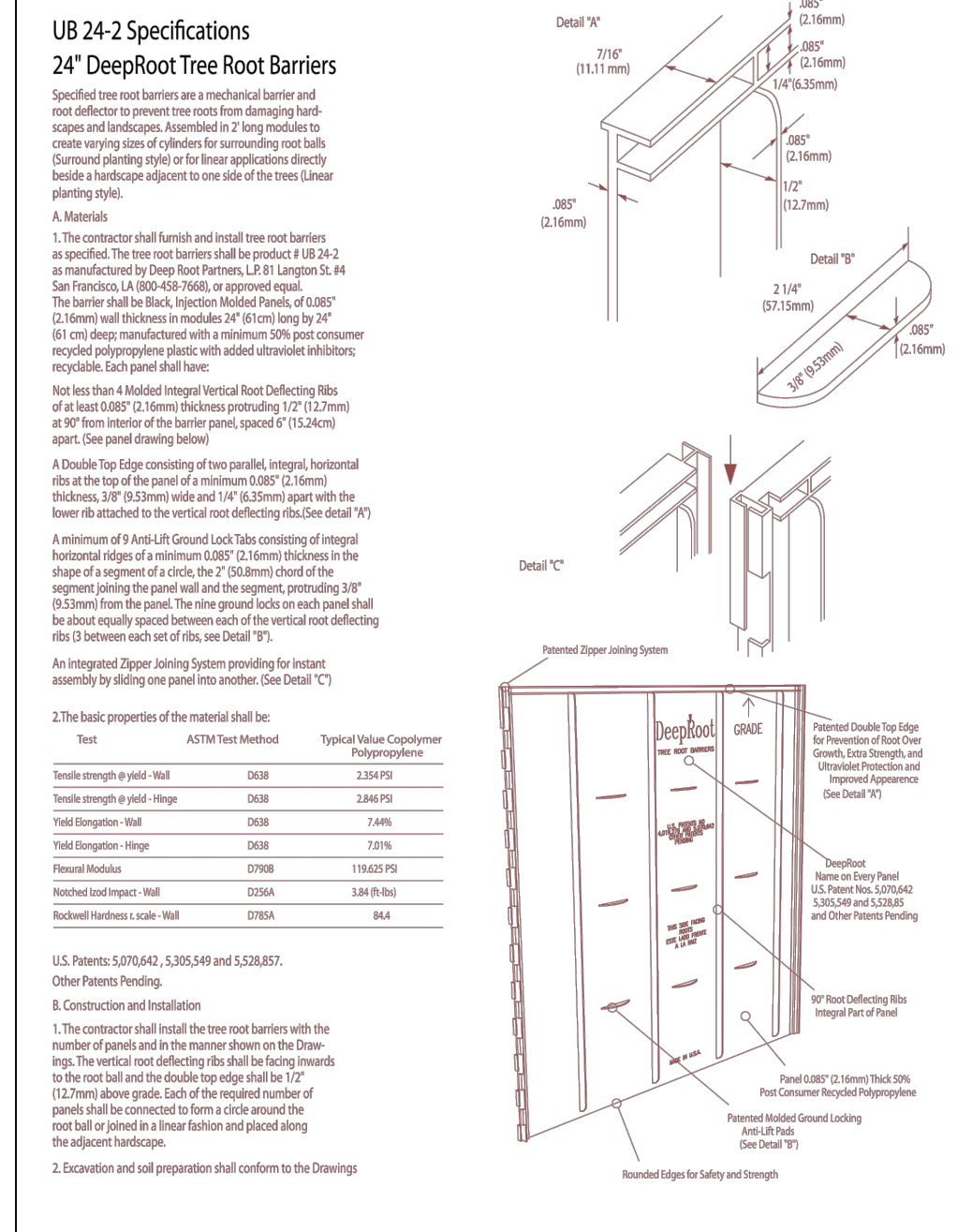

PLANT LIST									
Qty.	Common name	Botanical Name	Size	DBH	Spread	Native	Drought tolerance	Specifications	
TREES & PALMS									
1	Green Buttonwood	Conocarpus erectus	16'	6"	8'	YES	Tolerant	Lot trees + 4 (Mitigation trees) Florida Grade # 1 or better	
11	Silver Buttonwood	Conocarpus erectus 'sericeus'	16'	6"	8'	YES	Tolerant	(Mitigation trees) Florida Grade # 1 or better	
6	Alexander Palm	Ptychosperma elegans	22'-24' - 26' O.A.	6"	16'	NO	Tolerant	(4 Mitigation palms) Florida Grade # 1 or better	
1	Live Oak	Quercus virginiana	14'	3"	12'	YES	Tolerant	Florida Grade # 1 or better	
3	Silver Trumpet	Tabebuia caroba	16'	6"	10'	NO	Tolerant	Florida Grade # 1 or better	
1	Thatch Palm	Thrinax radiata (Double)	4'	6"	4'	YES	Tolerant	(Mitigation trees) Florida Grade # 1 or better	
Qty.	Common name	Botanical Name	Size	DBH	Spread	Native	Drought tolerance	Specifications	
SHRUBS & PALMS									
5	Simpson Stopper	Myrcianthes fragans	10'	2"	8'	YES	Tolerant	8 feet clear trunk - Florida Grade # 1 or better	
NOTE: 2 sheet trees will cover by free fund									
Live cost (5) = 2 x \$505		\$1,000.00							

NOTE: 2 steel lines will be cover by tree fund  
Area cost (5) = 2 x \$905  
\$1,810.00

PLANT LIST								
Qty.	Common name	Botanical Name	Size	Spread	Native	Drought tolerance	Specifications	
SHRUBS & GROUNDCOVERS								
3	Bromelia Imperialis	Alcantarea Imperialis	24"	24"	NO	Moderate	Florida Grade # 1 or better	
57	Ornamental peanuts	Arachis glabrata	12"	12"	NO	Tolerant	Florida Grade # 1 or better	
74	Green cocoplum	Chrysobalanus icaco 'Green'	24"	24"	YES	Tolerant	Florida Grade # 1 or better	
5	Queen Emma Citrum	Citrum agustum 'Queen Emma'	30"	30"	NO	Tolerant	Florida Grade # 1 or better	
2	King sago	Cyc sad revoluta	36"	36"	NO	Tolerant	Florida Grade # 1 or better	
142	Ficus Green Island	Ficus microcarpa 'Green Island'	24"	24"	NO	Moderate	Florida Grade # 1 or better	
5	Heliconia	Heliconia caribaea	48"	48"	NO	Tolerant	Florida Grade # 1 or better	
126	Simpson's stopper	Myrcianthes fragrans	4'	2.5'	YES	Tolerant	Florida Grade # 1 or better	
17	Blue Iris	Neomarpia apostolica	24"	24"	NO	Moderate	Florida Grade # 1 or better	
4	Panama rose	Rondeletia odorata	36"	36"	NO	Tolerant	Florida Grade # 1 or better	
9	Sand Cordgrass	Spartina bakeri	24"	24"	YES	Tolerant	Florida Grade # 1 or better	
27	Dwarf Fakaholohoe	Tripsacum floridanum	24"	24"	YES	Tolerant	Florida Grade # 1 or better	
SOD								
1,850 sq ft	Stenotaphrum secundatum 'Palmetto'	St. Augustine Grass			NO	Moderate	Florida Grade # 1 or better	
Note: -Plant spacing shall supersede plant quantity to fill the bed.								

Note: Plant spacing shall supersede plant quantity to fill the bed.